

# OCEANIS 48

Calypso\_DB

The Sailing yacht Oceanis 48 „Calypso\_DB“, built in 2014, is moored in Whitsundays, Airlie Beach, Coral Sea Marina, - Australia and Oceania. The yacht has 5 cabins, can accomodate 10 + 2 persons and has 3 toilets/showers.

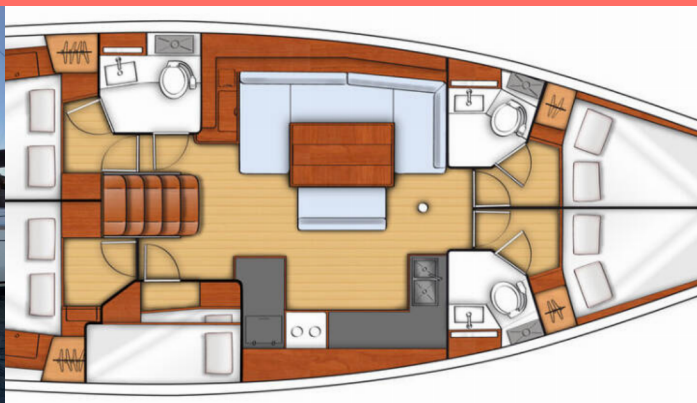

## YACHT SPECIFICATIONS

Charter Base

**Whitsundays, Airlie Beach, Coral Sea Marina, Australia and Oceania**

Yacht ID

**6433**

Brand

**Bénéteau**

Name

**Calypso\_DB**

Production Year

**2014**

Length

**14.60 m**

Cabins

**5**

Berths

**10 + 2**

Max. Passengers

**10**

Head/Shower

**3**

## STANDARD YACHT EQUIPMENT

Deck

Outboard engine (6hp)

Entertainment

FUSION sound system

Galley

Freezer, Hot water, Kitchen utensils (Galley equipment, cutlery), Oven (gas), Refrigerator, Stove (gas 3 burner)

Interior

Convertible table in salon, Electric fans

Navigation

Autopilot, Bow thruster, Compass, Depthsounder, GPS chart plotter (Inside), Nautical charts, Speedometer (Speed log), Wind instrument/Anemometer

Safety

Black Water Tank (128 l), VHF radio

Sails

Lazy bag, Lazy jacks

Yacht electrics

220V socket (220-240V), Air Conditioning (A/C only dockside ), Battery charger , Inverter, Shore connection 220 V, WC pump (electric)