

LAGOON 55

Valinor (Crewed)

The Catamaran Lagoon 55 „Valinor (Crewed)“, built in 2023, is moored in BVI, Tortola, Nanny Cay Marina, - British Virgin Islands. The yacht has 6 + 2 cabins, can accomodate 12 + 2 persons and has 6 toilets/showers.

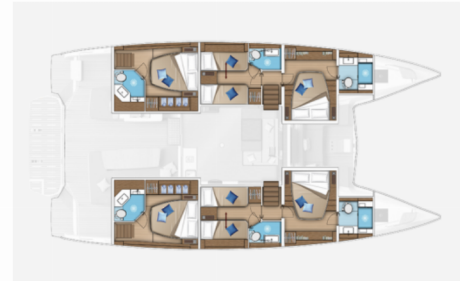

YACHT SPECIFICATIONS

Charter Base

BVI, Tortola, Nanny Cay Marina, British Virgin Islands

Yacht ID

1418

Brand

Lagoon-Bénéteau

Name

Valinor (Crewed)

Production Year

2023

Length

16.56 m

Cabins

6 + 2

Berths

12 + 2

Max. Passengers

12

Head/Shower

6

STANDARD YACHT EQUIPMENT

Comfort

Blankets, Pillows

Deck

Bar (BAR FURNITURE (SINK AND FRIDGE 24V-70L)), Camera (RAYMARINE CAMERAS), Cockpit light, Cockpit table, Dinghy hydraulic lifting system, Dinghy with outboard engine (Highfield RIB 420 SPORT HYPALON & Engine Honda BF 60 LRTU. S/steel dinghy hoist system & manual winches (Max load: 500kg/1,103lbs) Donut comes with dinghy.), Grill/Barbecue/Plancha, Hard Top Bimini (COMPOSITE BIMINI WITH WINDOWS, LED LIGHTS, WINDSHIELD AND ATHERMAL CURTAINS (Color: according to exterior upholsteries and canvas choice)), Hydraulic lifting swimming platform, Remote control for anchor winch with chain counter at helm, Swimming ladder, Teak cockpit (SYNTHETIC TEAK ON FORWARD & AFT COCKPIT AND TRANSOMS), Teak table (FLYBRIDGE FOLDING TEAK TABLE WITH COVER (Color: according to exterior upholsteries and canvas choice))

Entertainment

eFoil, Floating mats (Water Mat), FUSION sound system (Fusion Apollo MS-RA670 player in the salon & 4 loudspeakers (Salon x2 - Aft cockpit x2)), Kayak (Aqua Marina Kayak), Seabob, Snorkeling equipment (Aqualung Snorkel Gear – Wide variety of sizes), Stand up paddle (SUP) (SUP with LOGO of Shipname), Starlink (Internet), Towables (Towable Water Lounger), Underwater lights (4 UNDER WATER LED SPOT LIGHTS (Color: blue)), Underwater scooter (Subnado Underwater Scooter), Wakeboard, Water skis ((junior / female / male)), Windsurf

Galley

Bin bag, Dishwasher, Freezer (FREEZER 24V-90L), Freshwater treatment plant (advanced water purifier with eco-friendly refillable bottles. It purifies water from any source, ensuring safe, clean hydration on the go), Kitchen utensils (Galley equipment, cutlery) (Galley accessories and storages kit (starboard)), Microwave, Refrigerator (FRIDGE 24V-70L), Water pump

Interior

Electric fans (Fans in salon and cabins), Electric toilet, Indirect lighting in cabins and salon, Upholstery (INSIDE UPHOLSTERY (salon & settees): GRAND COMFORT ARDOISE)

Navigation

Autopilot (2023 RAYMARINE NAVIGATION PACK - Multifunction i70s display at helm station - P70s autopilot + ACU-400 actuator control unit + gyro - Speed/Depth/Temp Transducer - Wind transducer - RAY90 VHF - AIS700 transceiver - Axiom Pro 16" display at helm station - 3 Navionics Silver cards (EU, US, ROW) - Multifunction i70s display at chart table - Wireless handset at helm station for VHF RAY90), Bow thruster (ELECTRICAL BOW THRUSTER 24V 170 KGF ON STARBOARD WITH DEDICATED BATTERIES (4x50A) AND CHARGER 30A), Compass, GPS chart plotter, LED Navigation lights, Radar (RAYMARINE QUANTUM 2 DOPPLER RADAR)

Safety

Distress flare box, First aid kit , SAT phone (Iridium Satellite Phone), Torch, VHF radio

Sails

Code Zero (CODE 0 GEAR WITH POLE & ELECTRIC FURLER CODE 0 D4 KEVLAR (154m²/1,657sq.ft)), Electric Flatwinder (FLATWINDER IN LIEU OF STANDARD), Electric winch (ALL ELECTRIC WINCHES), Sails (GSE - Modification Bande Anti-UV Saphir 6720), Self tailing (manual) winch

Yacht electrics

230 volt socket (230V outlets), Air Conditioning (AIR CONDITIONING FOR 6 CABIN VERSION (94 000 BTU)), Batteries, Battery charger (ADDITIONAL CHARGER 24V/100A), Generator (NL GENERATOR 16 KW 60HZ), Inverter (120V/60Hz SPECIFICATIONS (USA outlets & dedicated inverter 3kVA 24/120V)), Service batteries (Service gel batteries 4x210A (Standard: 6x140A AGM)), Shore power cable (Electrical circuit 230V with 63A shore power, 230V outlets), Solar panels (FLEXIBLE SOLAR PANELS ON COMPOSITE BIMINI (8x115W)), USB sockets, Watermaker - desalinator (2x Watermaker WATERMAKER 100L/H 220V), WC pump