

ELAN IMPRESSION 50

Biondi

The Sailing yacht Elan Impression 50 „Biondi“, built in 2015, is moored in Marina Kastela, Split - Croatia. The yacht has 5 cabins, can accommodate 10 + 2 persons and has 2 toilets/showers.

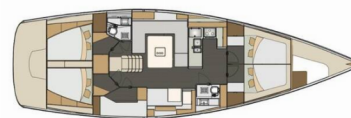
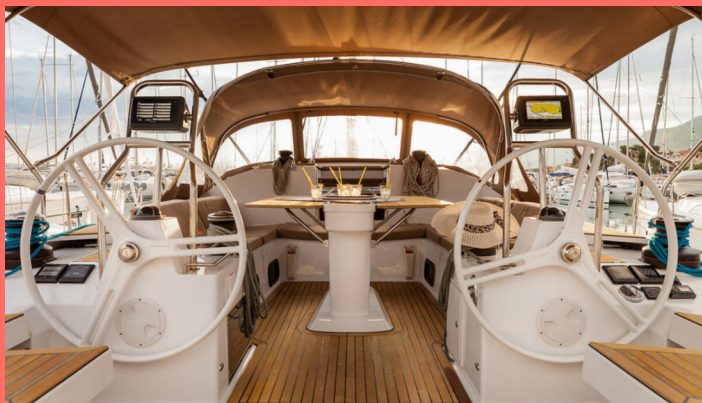

YACHT SPECIFICATIONS

Charter Base

Marina Kastela, Croatia

Yacht ID

129

Brand

Elan Marine

Name

Biondi

Production Year

2015

Length

15.20 m

Cabins

5

Berths

10 + 2

Max. Passengers

12

Head/Shower

2

STANDARD YACHT EQUIPMENT

Comfort

Cockpit cushions, Sundeck cushions

Deck

Anchor with chain, Bathing platform, Bimini top, Cockpit table, Cockpit/stern, outside shower, Dinghy, Electric anchor windlass, LED outdoor ambiance lights, Sprayhood

Entertainment

Radio CD mp3 player + USB, TV + DVD, Underwater lights

Galley

Hot water, Kitchen utensils (Galley equipment, cutlery), Oven, Refrigerator ((2 inside, 1 in the cockpit))

Interior

Convertible table, LED interior lights, Teak interior

Navigation

Autopilot, Bow thruster, Compass, Echosounder/Depthsounder, GPS chart plotter - cockpit, Navigation (Nautical) charts and nautical guide, Navigation set, Radar, Wind instrument/Anemometer

Safety

Black Water Tank, First aid kit, Life jackets, Liferaft, Safety equipment, Set of tools, VHF radio

Yacht electrics

Air Conditioning (cooling and heating only 220 V), Inverter, Shore connection 220 V